

# Threaded Cross, Galvanized Malleable Iron, Class 150 Inches / Pounds

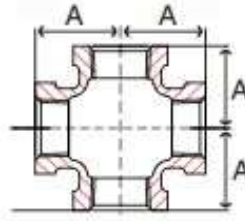

Part #	Size	A (center to end)	Approximate Weight (in Lbs.)
KTC.125MIG	1/8	0.56	0.02
KTC.25MIG	1/4	0.66	0.02
KTC.375MIG	3/8	0.66	0.30
KTC.5MIG	1/2	0.75	0.30
KTC.75MIG	3/4	0.75	0.60
KTC1MIG	1	0.75	1.10
KTC1.25MIG	1-1/4	0.84	1.40
KTC1.5MIG	1-1/2	0.84	1.90
KTC2MIG	2	0.84	2.80
KTC2.5MIG	2-1/2	0.84	5.00
KTC3MIG	3	1.00	7.30
KTC4MIG	4	1.00	12.60

***\*Malleable iron castings conform to ASTM A197***

***\*Hot-dipped galvanized fittings conform to ASTM A15***

***\*Hot-dipped galvanized fittings are certified to NSF/ANSI 61-4 and California AB1953 Lead Free***

***\*Dimensions conform to ASME B16.3***

***\*NPT Threads on all fittings conform to ASME B1.20.1***